



Mallard Pass

Solar Farm

Mallard Pass Solar Farm

Traffic Regulation Measures Plans - Temporary Measures

January 2022

PINS Ref: EN010127

Document Ref: EN010127/APP/2.7

Revision P1

Infrastructure Planning (Applications: Prescribed Forms and Procedure) Regulations
2009 - Reg 5 (2) (o)



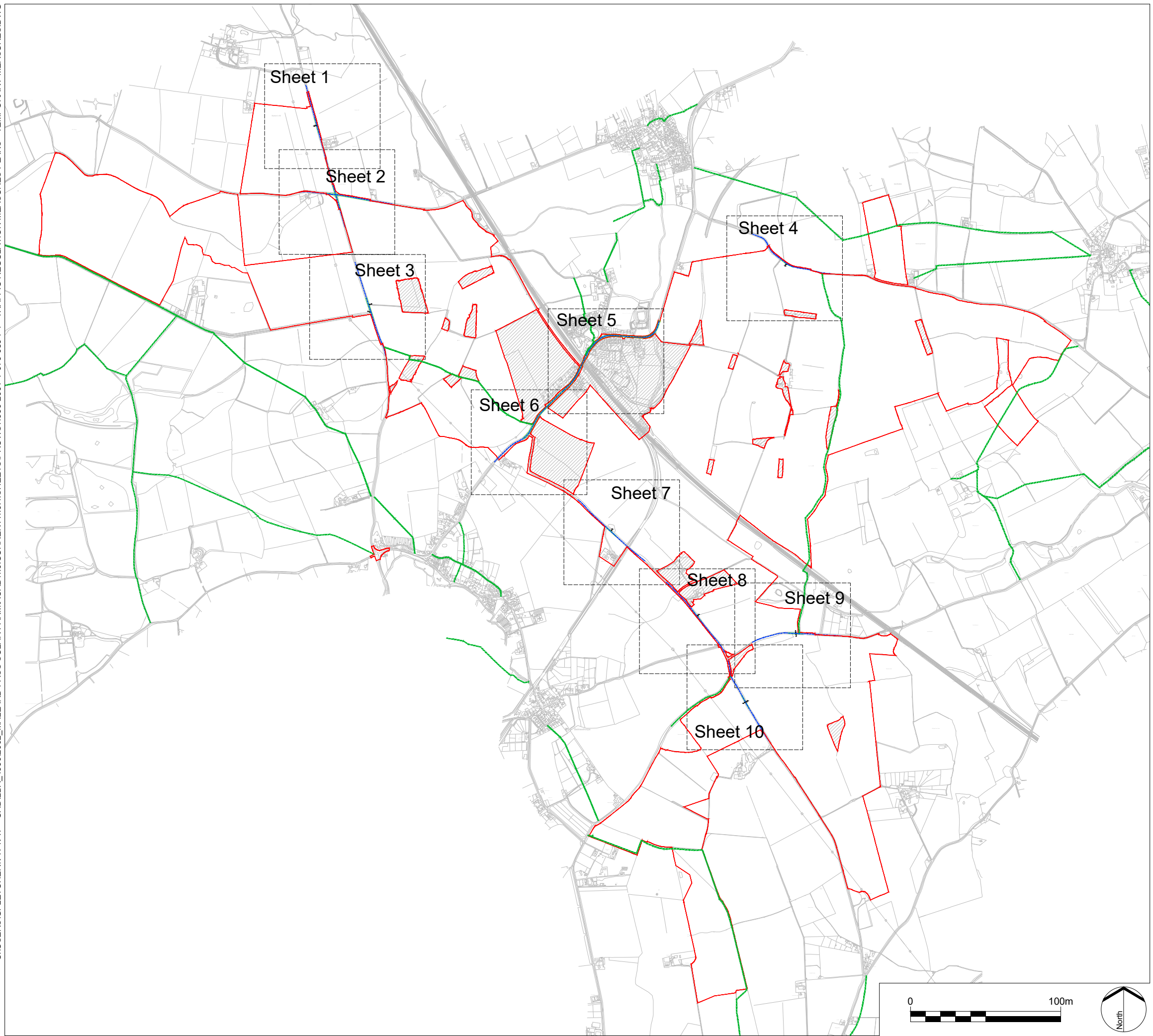



C:\USERS\GFLETCHER\PTVP - CAD\LDA_49902002_MALLARD PASS SOLAR FARM\CAD11.0.CURRENT\11.0.1.SHEETS\PROWS\4990-2001-T-079-089-P1 - TRAFFIC REGULATION MEASURES PLANS - TEMPORARY MEASURES.DWG

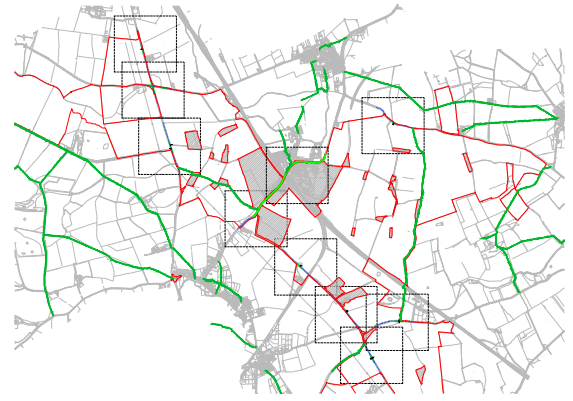

LEGEND

KEY PLAN:



-  Order limits
-  Areas outside of Order limits
-  Proposed Temporary Speed Limit (30mph Speed Limit)
-  Proposed Temporary Traffic Signal Control Area
-  Proposed Site Access Location
-  Existing public right of way

- NOTES:
1. The Traffic Regulation Measures Plans should be read in conjunction with the Development Consent Order and the other plans and documents to be certified under it, in particular article 15, and Schedule 8 of the Development Consent Order.
 2. Information relating to the Public Rights of Way and accesses can be found on the rights of way and access plans.
 3. The Order limits has been drawn to the Land Registry boundaries and topographical survey data of the site. The accuracy of land registry and the topographical survey differs from the OS base mapping which results in the order limits not aligning with the line work shown on the OS mapping.
 4. Further information on the Public Rights of Way can be found on Figure 6.5 of the Environmental Statement.

P1	Addition of existing PRoW	RP	18/01/23
P0	Submission	RP	18/11/22
REV.	DESCRIPTION	APP.	DATE



PROJECT TITLE
MALLARD PASS SOLAR FARM

DRAWING TITLE
TRAFFIC REGULATION MEASURES PLANS - TEMPORARY MEASURES - KEY PLAN
Infrastructure Planning (Applications: Prescribed Forms and Procedure) Regulations 2009
APFP Regulation: 5(2)(o)

PINS REFERENCE NO
EN010127

ISSUED BY	Oxford	T: 01865 887 050
DATE	18 NOV 2022	DRAWN GSF
SCALE@A3	1:2,500	CHECKED CR
STATUS	Planning	APPROVED RP

DWG. NO 4990-2001-T-079 **REV : P1**

No dimensions are to be scaled from this drawing.
All dimensions are to be checked on site.
Area measurements for indicative purposes only.

© LDA Design Consulting Ltd. Quality Assured to BS EN ISO 9001 : 2015
Sources Ordnance Survey

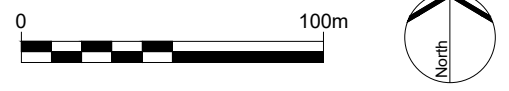

C:\USERS\GFLETCHER\PTVP - CAD\LDA_49902002_MALLARD PASS SOLAR FARM\CAD11.0.CURRENT\11.0.1.SHEETS\PROWS\4990-2001-T-079-089-P1 - TRAFFIC REGULATION MEASURES PLANS - TEMPORARY MEASURES.DWG

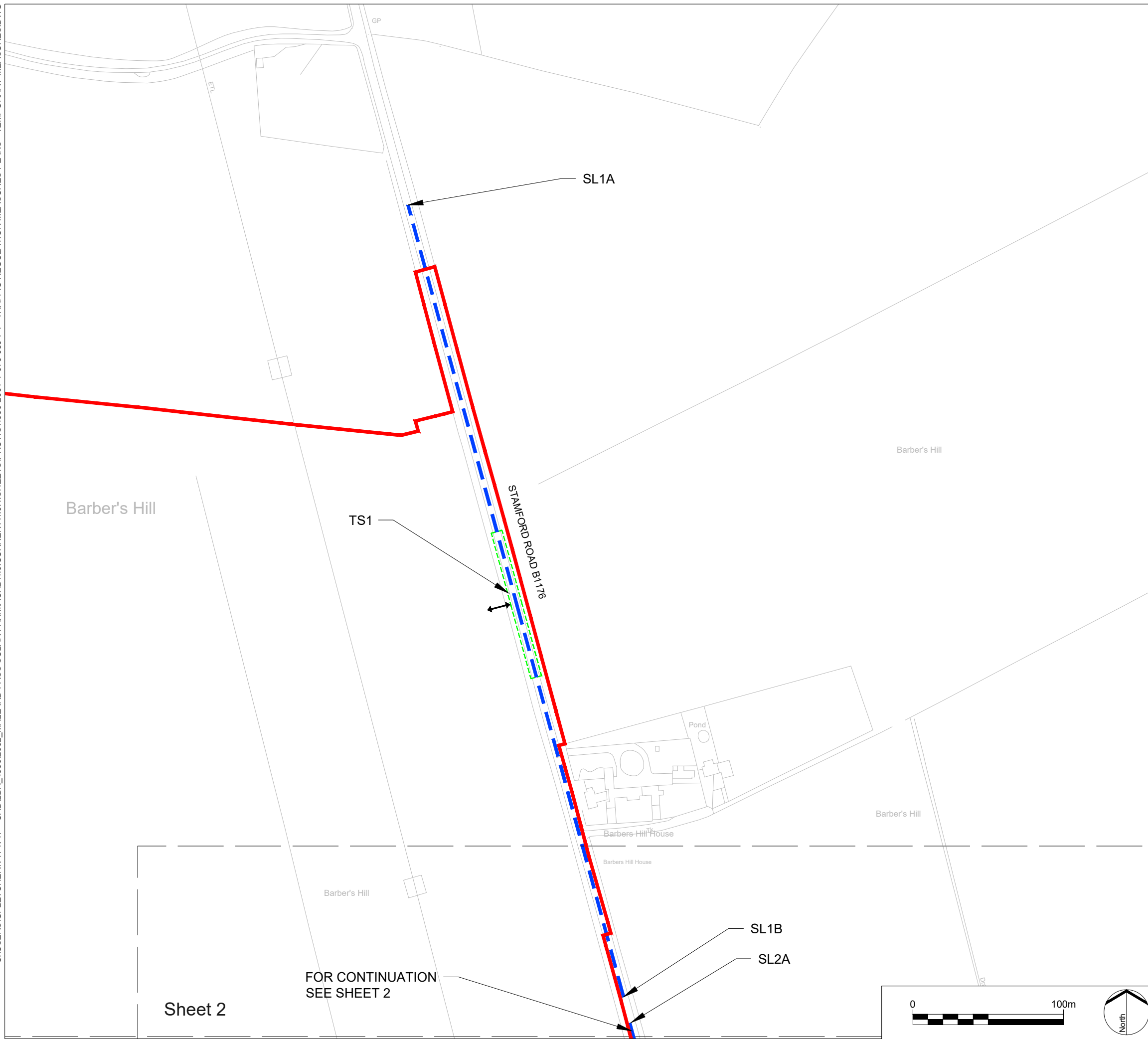

LEGEND

KEY PLAN:

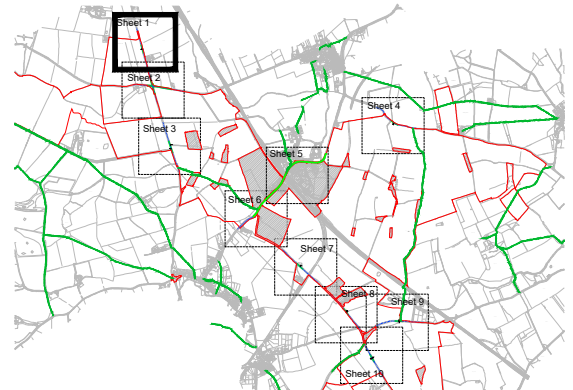

- Order limits
- Areas outside of Order limits
- Proposed Temporary Speed Limit (30mph Speed Limit)
- Proposed Temporary Traffic Signal Control Area
- Proposed Site Access Location
- Existing public right of way

- NOTES:
1. The Traffic Regulation Measures Plans should be read in conjunction with the Development Consent Order and the other plans and documents to be certified under it, in particular article 15, and Schedule 8 of the Development Consent Order.
 2. Information relating to the Public Rights of Way and accesses can be found on the rights of way and access plans.
 3. The Order limits has been drawn to the Land Registry boundaries and topographical survey data of the site. The accuracy of land registry and the topographical survey differs from the OS base mapping which results in the order limits not aligning with the line work shown on the OS mapping.
 4. Further information on the Public Rights of Way can be found on Figure 6.5 of the Environmental Statement.

P1	Addition of existing PRoW	RP	18/01/23
P0	Submission	RP	18/11/22
REV.	DESCRIPTION	APP.	DATE



PROJECT TITLE
MALLARD PASS SOLAR FARM

DRAWING TITLE
TRAFFIC REGULATION MEASURES PLANS - TEMPORARY MEASURES - SHEET 1 OF 10
 Infrastructure Planning (Applications: Prescribed Forms and Procedure) Regulations 2009
 APFP Regulation: 5(2)(o)

PINS REFERENCE NO
EN010127

ISSUED BY	Oxford	T: 01865 887 050
DATE	18 NOV 2022	DRAWN GSF
SCALE@A3	1:2,500	CHECKED CR
STATUS	Planning	APPROVED RP

DWG. NO 4490-2001-T-080 REV : P1

No dimensions are to be scaled from this drawing.
 All dimensions are to be checked on site.
 Area measurements for indicative purposes only.

© LDA Design Consulting Ltd. Quality Assured to BS EN ISO 9001 : 2015
 Sources Ordnance Survey

C:\USERS\GFLETCHER\PTV\PT - CAD\LDA_49902002_MALLARD_PASS SOLAR FARM\CAD11.0.CURRENT\11.0.1.SHEETS\PROWS\4990-2001-T-079-089-P1 - TRAFFIC REGULATION MEASURES PLANS - TEMPORARY MEASURES.DWG

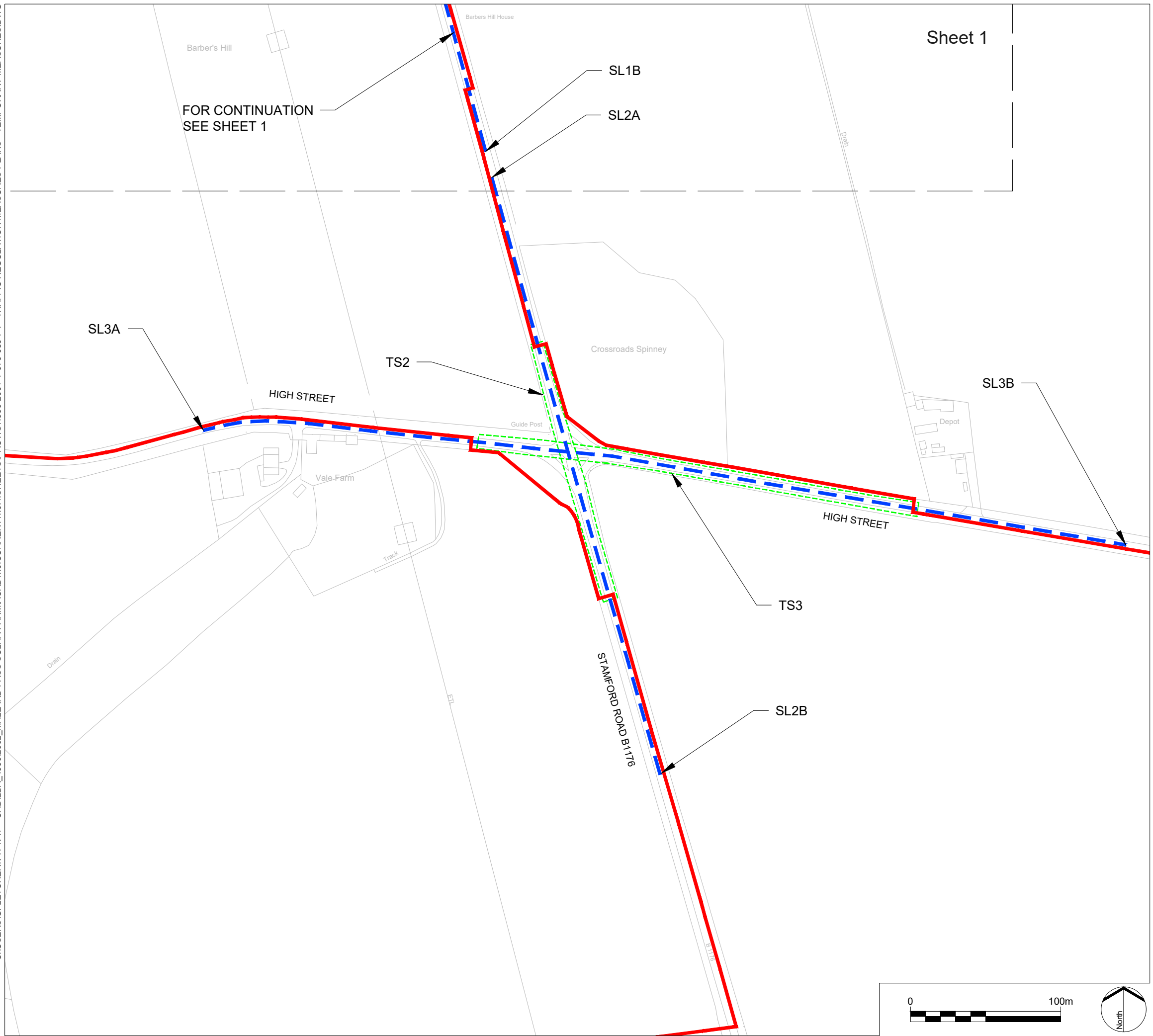

FOR CONTINUATION
SEE SHEET 1

Sheet 1

LEGEND

KEY PLAN:

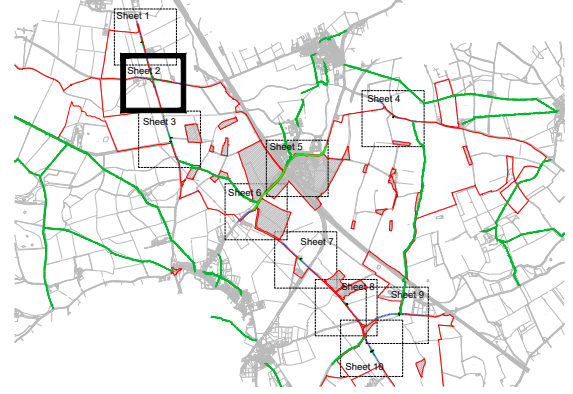

- Order limits
- Areas outside of Order limits
- Proposed Temporary Speed Limit (30mph Speed Limit)
- Proposed Temporary Traffic Signal Control Area
- Proposed Site Access Location
- Existing public right of way

NOTES:

1. The Traffic Regulation Measures Plans should be read in conjunction with the Development Consent Order and the other plans and documents to be certified under it, in particular article 15, and Schedule 8 of the Development Consent Order.
2. Information relating to the Public Rights of Way and accesses can be found on the rights of way and access plans.
3. The Order limits has been drawn to the Land Registry boundaries and topographical survey data of the site. The accuracy of land registry and the topographical survey differs from the OS base mapping which results in the order limits not aligning with the line work shown on the OS mapping.
4. Further information on the Public Rights of Way can be found on Figure 6.5 of the Environmental Statement.

REV.	DESCRIPTION	RP	APP. DATE
P1	Addition of existing PRoW	RP	18/01/23
P0	Submission	RP	18/11/22



PROJECT TITLE
MALLARD PASS SOLAR FARM

DRAWING TITLE
TRAFFIC REGULATION MEASURES PLANS - TEMPORARY MEASURES - SHEET 2 OF 10
Infrastructure Planning (Applications: Prescribed Forms and Procedure) Regulations 2009
APFP Regulation: 5(2)(o)

PINS REFERENCE NO
EN010127

ISSUED BY	Oxford	T: 01865 887 050
DATE	18 NOV 2022	DRAWN GSF
SCALE@A3	1:2,500	CHECKED CR
STATUS	Planning	APPROVED RP

DWG. NO 4990-2001-T-081 REV : P1

No dimensions are to be scaled from this drawing.
All dimensions are to be checked on site.
Area measurements for indicative purposes only.

© LDA Design Consulting Ltd. Quality Assured to BS EN ISO 9001 : 2015
Sources Ordnance Survey

C:\USERS\GFLETCHE\TVP\TVP - CAD\LDA_49902002_MALLARD PASS SOLAR FARM\CAD11.0.CURRENT\11.0.1.SHEETS\PROWS\4990-2001-T-079-089-P1 - TRAFFIC REGULATION MEASURES PLANS - TEMPORARY MEASURES.DWG

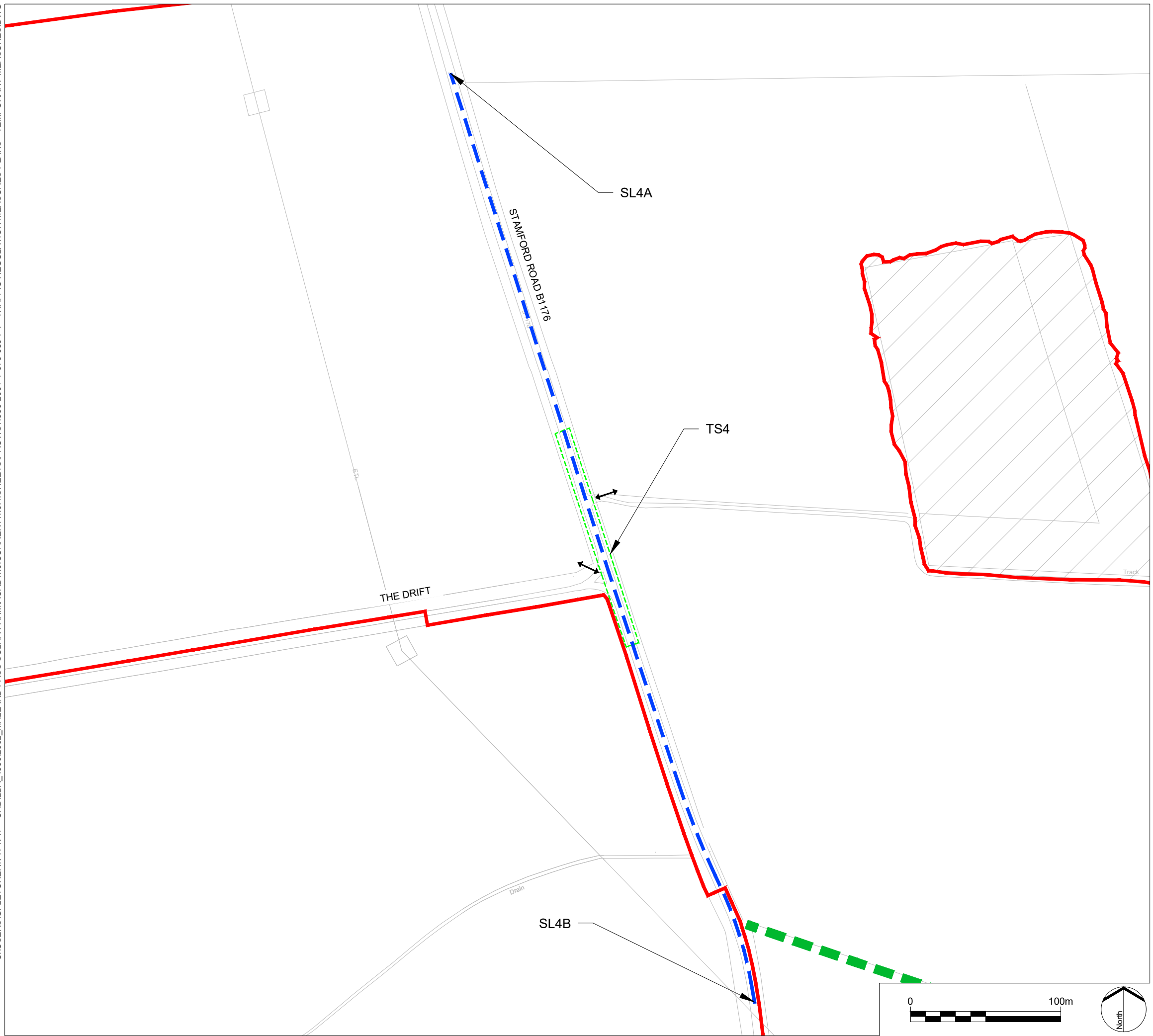

LEGEND

KEY PLAN:

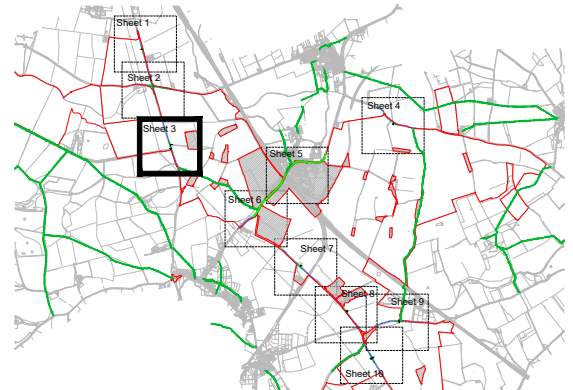

- Order limits
- Areas outside of Order limits
- Proposed Temporary Speed Limit (30mph Speed Limit)
- Proposed Temporary Traffic Signal Control Area
- Proposed Site Access Location
- Existing public right of way

- NOTES:
- The Traffic Regulation Measures Plans should be read in conjunction with the Development Consent Order and the other plans and documents to be certified under it, in particular article 15, and Schedule 8 of the Development Consent Order.
 - Information relating to the Public Rights of Way and accesses can be found on the rights of way and access plans.
 - The Order limits has been drawn to the Land Registry boundaries and topographical survey data of the site. The accuracy of land registry and the topographical survey differs from the OS base mapping which results in the order limits not aligning with the line work shown on the OS mapping.
 - Further information on the Public Rights of Way can be found on Figure 6.5 of the Environmental Statement.

REV.	DESCRIPTION	APP. DATE
P1	Addition of existing PRoW	RP 18/01/23
P0	Submission	RP 18/11/22



PROJECT TITLE
MALLARD PASS SOLAR FARM

DRAWING TITLE
TRAFFIC REGULATION MEASURES PLANS - TEMPORARY MEASURES - SHEET 3 OF 10
 Infrastructure Planning (Applications: Prescribed Forms and Procedure) Regulations 2009
 APFP Regulation: 5(2)(o)

PINS REFERENCE NO
EN010127

ISSUED BY	Oxford	T: 01865 887 050
DATE	18 NOV 2022	DRAWN GSF
SCALE@A3	1:2,500	CHECKED CR
STATUS	Planning	APPROVED RP

DWG. NO 4990-2001-T-082 REV : P1

No dimensions are to be scaled from this drawing.
 All dimensions are to be checked on site.
 Area measurements for indicative purposes only.

© LDA Design Consulting Ltd. Quality Assured to BS EN ISO 9001 : 2015
 Sources Ordnance Survey

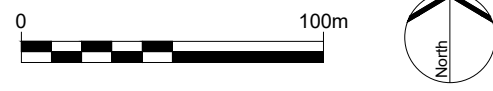

C:\USERS\GFLETCHER\PTV\PT - CAD\LDA_4990\2002_MALLARD PASS SOLAR FARM\CAD11.0.CURRENT\11.0.1.SHEETS\PROWS\4990-2001-T-079-089-P1 - TRAFFIC REGULATION MEASURES PLANS - TEMPORARY MEASURES.DWG

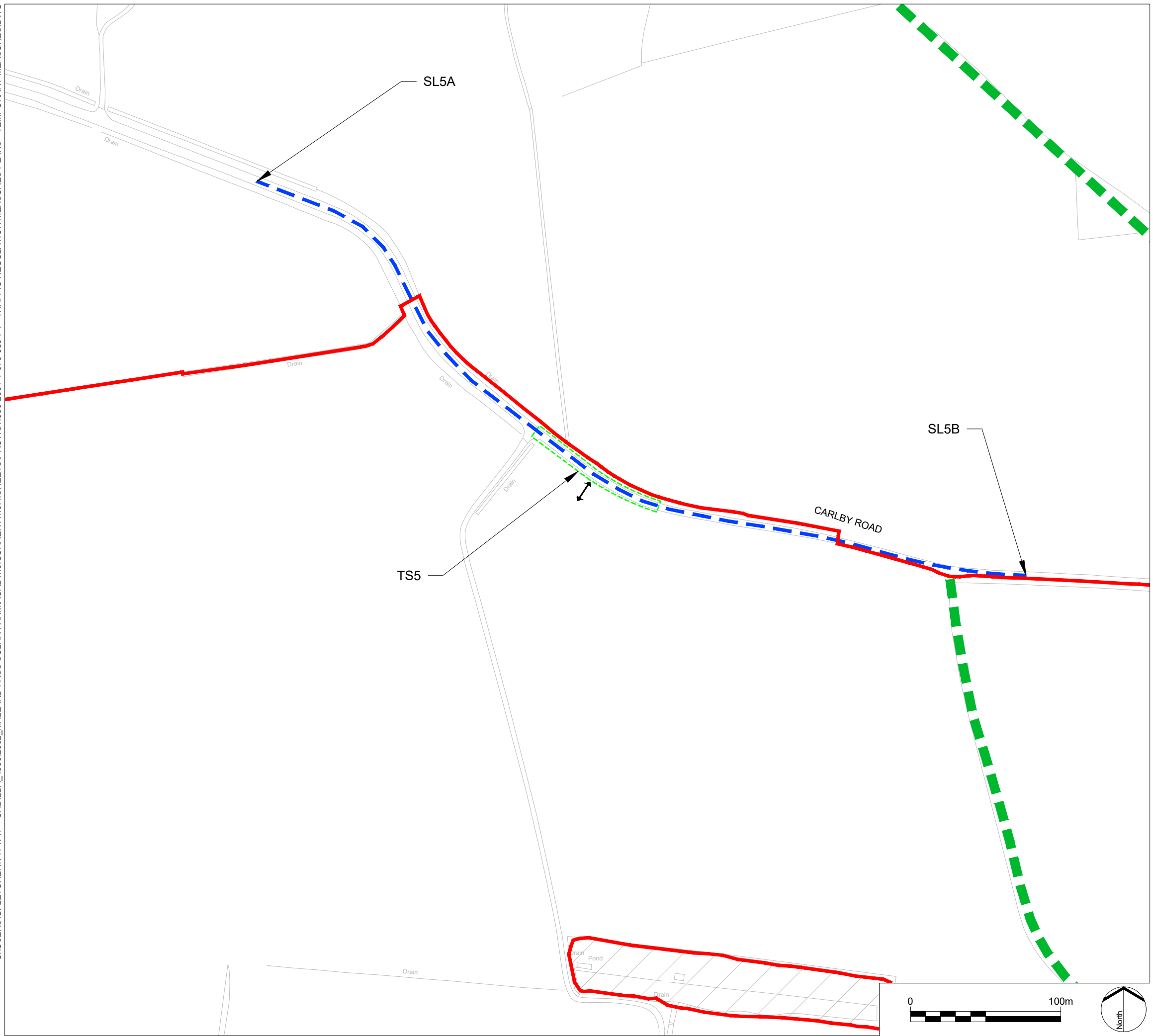

LEGEND

KEY PLAN:

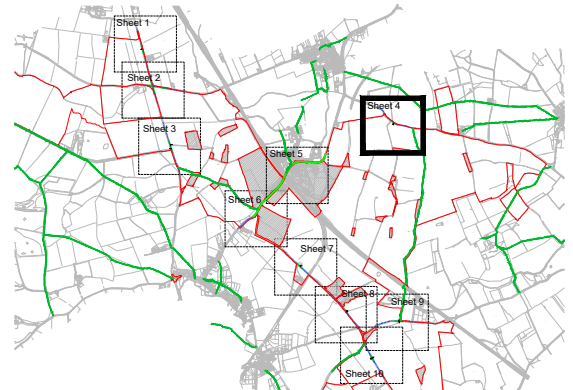

- Order limits
- Areas outside of Order limits
- Proposed Temporary Speed Limit (30mph Speed Limit)
- Proposed Temporary Traffic Signal Control Area
- Proposed Site Access Location
- Existing public right of way

- NOTES:
1. The Traffic Regulation Measures Plans should be read in conjunction with the Development Consent Order and the other plans and documents to be certified under it, in particular article 15, and Schedule 8 of the Development Consent Order.
 2. Information relating to the Public Rights of Way and accesses can be found on the rights of way and access plans.
 3. The Order limits has been drawn to the Land Registry boundaries and topographical survey data of the site. The accuracy of land registry and the topographical survey differs from the OS base mapping which results in the order limits not aligning with the line work shown on the OS mapping.
 4. Further information on the Public Rights of Way can be found on Figure 6.5 of the Environmental Statement.

REV.	DESCRIPTION	APP. DATE
P1	Addition of existing PRoW	RP 18/01/23
P0	Submission	RP 18/11/22



PROJECT TITLE
MALLARD PASS SOLAR FARM

DRAWING TITLE
TRAFFIC REGULATION MEASURES PLANS - TEMPORARY MEASURES - SHEET 4 OF 10
 Infrastructure Planning (Applications: Prescribed Forms and Procedure) Regulations 2009
 APFP Regulation: 5(2)(o)

PINS REFERENCE NO
EN010127

ISSUED BY	Oxford	T: 01865 887 050
DATE	18 NOV 2022	DRAWN GSF
SCALE@A3	1:2,500	CHECKED CR
STATUS	Planning	APPROVED RP

DWG. NO 4990-2001-T-083 REV : P1

No dimensions are to be scaled from this drawing.
 All dimensions are to be checked on site.
 Area measurements for indicative purposes only.

© LDA Design Consulting Ltd. Quality Assured to BS EN ISO 9001 : 2015
 Sources Ordnance Survey

C:\USERS\GFL\TCHER\TPVTP - CAD\LDA_4990\2002_MALLARD PASS SOLAR FARM\CAD\11.0.CURRENT\11.0.1.SHEETS\PROWS\4990-2001-T-079-089-P1 - TRAFFIC REGULATION MEASURES PLANS - TEMPORARY MEASURES.DWG

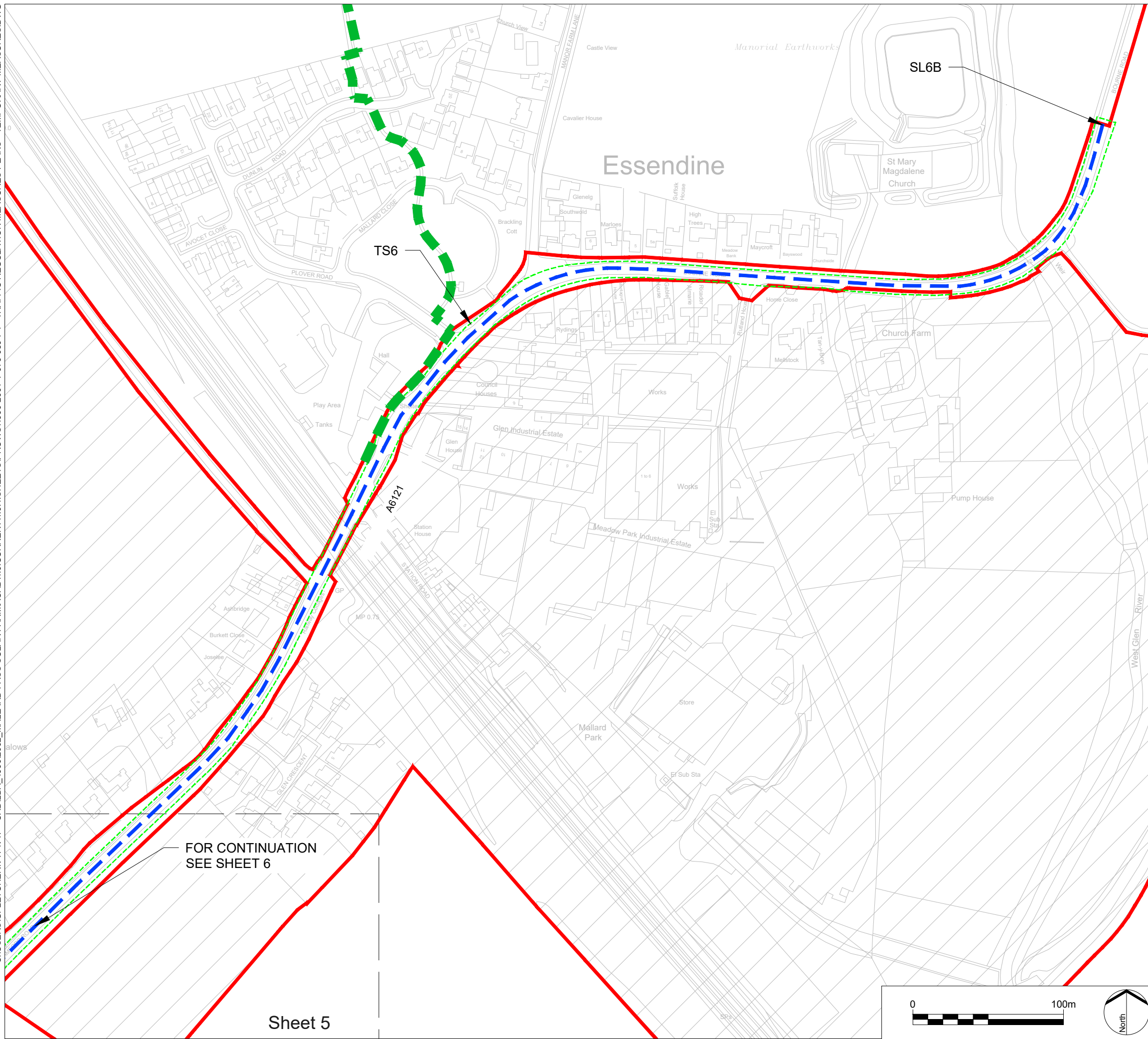

LEGEND

KEY PLAN:

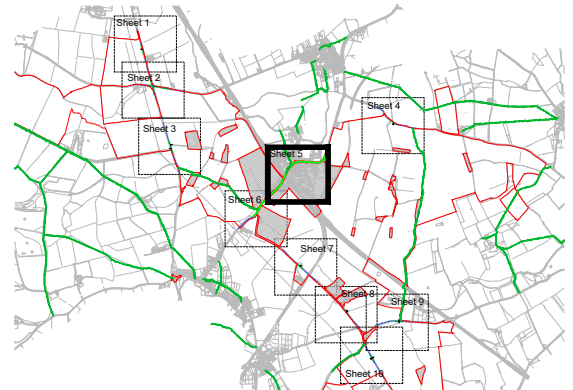

- Order limits
- Areas outside of Order limits
- Proposed Temporary Speed Limit (30mph Speed Limit)
- Proposed Temporary Traffic Signal Control Area
- Proposed Site Access Location
- Existing public right of way

- NOTES:
1. The Traffic Regulation Measures Plans should be read in conjunction with the Development Consent Order and the other plans and documents to be certified under it, in particular article 15, and Schedule 8 of the Development Consent Order.
 2. Information relating to the Public Rights of Way and accesses can be found on the rights of way and access plans.
 3. The Order limits has been drawn to the Land Registry boundaries and topographical survey data of the site. The accuracy of land registry and the topographical survey differs from the OS base mapping which results in the order limits not aligning with the line work shown on the OS mapping.
 4. Further information on the Public Rights of Way can be found on Figure 6.5 of the Environmental Statement.

REV.	DESCRIPTION	APP. DATE
P1	Addition of existing PRoW	RP 18/01/23
P0	Submission	RP 18/11/22



PROJECT TITLE
MALLARD PASS SOLAR FARM

DRAWING TITLE
TRAFFIC REGULATION MEASURES PLANS - TEMPORARY MEASURES - SHEET 5 OF 10
 Infrastructure Planning (Applications: Prescribed Forms and Procedure) Regulations 2009
 APFP Regulation: 5(2)(o)

PINS REFERENCE NO
EN010127

ISSUED BY	Oxford	T: 01865 887 050
DATE	18 NOV 2022	DRAWN GSF
SCALE@A3	1:2,500	CHECKED CR
STATUS	Planning	APPROVED RP

DWG. NO 4990-2001-T-084 REV : P1

No dimensions are to be scaled from this drawing.
 All dimensions are to be checked on site.
 Area measurements for indicative purposes only.

© LDA Design Consulting Ltd. Quality Assured to BS EN ISO 9001 : 2015
 Sources Ordnance Survey

Sheet 5

C:\USERS\GFLETCHER\PTVP - CAD\LDA_49902002_MALLARD PASS SOLAR FARM\CAD\1.0.1.SHEETS\PROWS\4990-2001-T-079-089-P1 - TRAFFIC REGULATION MEASURES PLANS - TEMPORARY MEASURES.DWG

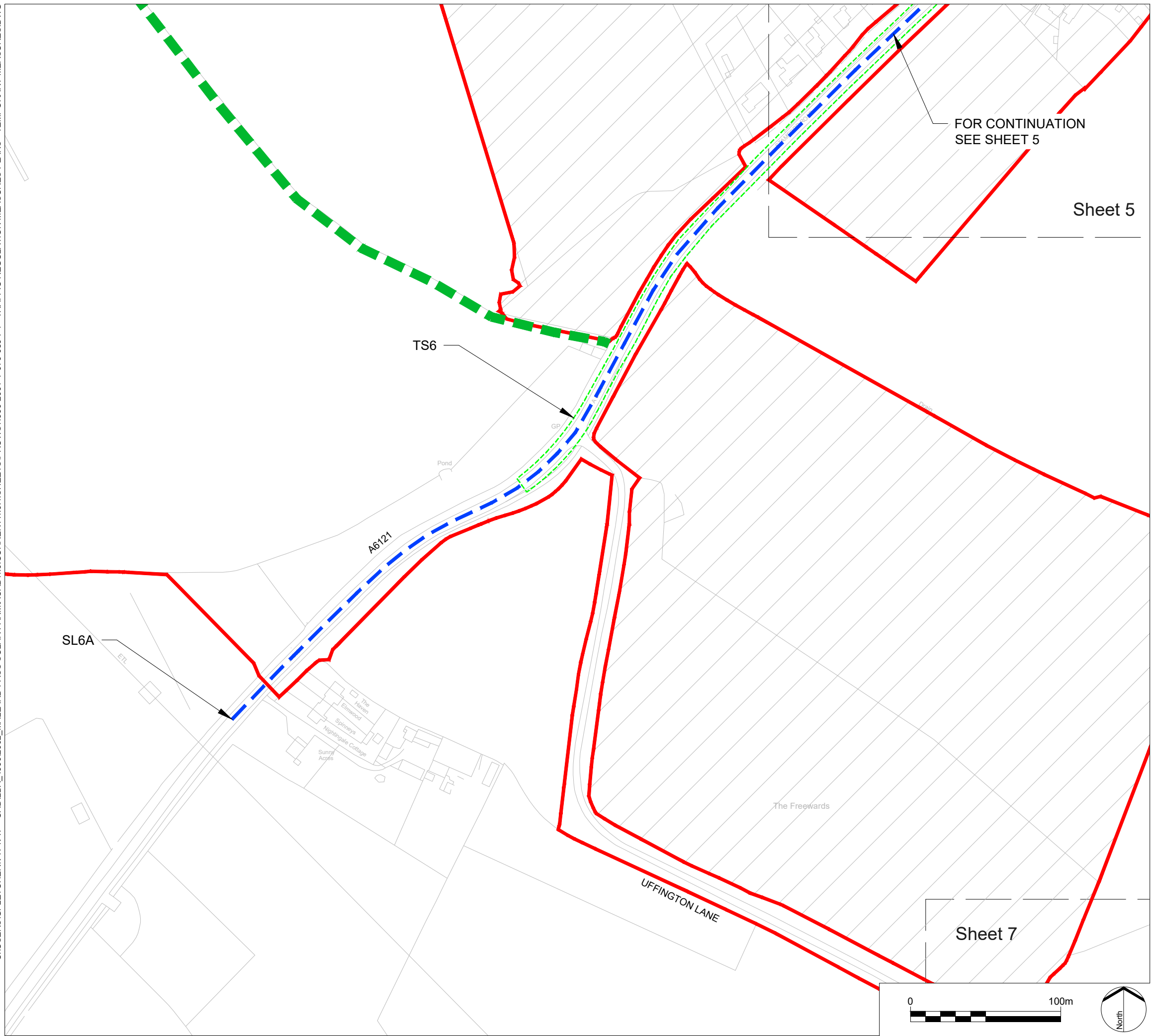

FOR CONTINUATION
SEE SHEET 5

Sheet 5

Sheet 7

LEGEND

KEY PLAN:

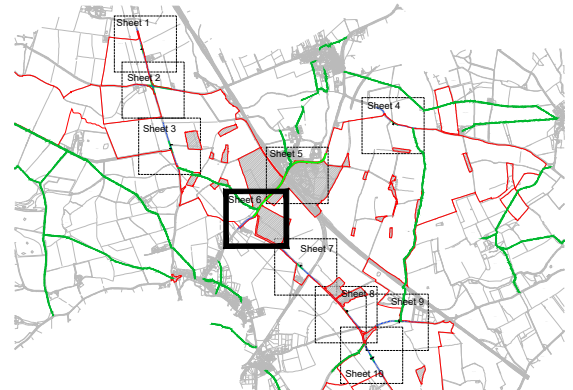

- Order limits
- Areas outside of Order limits
- Proposed Temporary Speed Limit (30mph Speed Limit)
- Proposed Temporary Traffic Signal Control Area
- Proposed Site Access Location
- Existing public right of way

- NOTES:
1. The Traffic Regulation Measures Plans should be read in conjunction with the Development Consent Order and the other plans and documents to be certified under it, in particular article 15, and Schedule 8 of the Development Consent Order.
 2. Information relating to the Public Rights of Way and accesses can be found on the rights of way and access plans.
 3. The Order limits has been drawn to the Land Registry boundaries and topographical survey data of the site. The accuracy of land registry and the topographical survey differs from the OS base mapping which results in the order limits not aligning with the line work shown on the OS mapping.
 4. Further information on the Public Rights of Way can be found on Figure 6.5 of the Environmental Statement.

REV.	DESCRIPTION	APP. DATE
P1	Addition of existing PRoW	RP 18/01/23
P0	Submission	RP 18/11/22



PROJECT TITLE
MALLARD PASS SOLAR FARM

DRAWING TITLE
TRAFFIC REGULATION MEASURES PLANS - TEMPORARY MEASURES - SHEET 6 OF 10
Infrastructure Planning (Applications: Prescribed Forms and Procedure) Regulations 2009
APFP Regulation: 5(2)(o)

PINS REFERENCE NO
EN010127

ISSUED BY	Oxford	T: 01865 887 050
DATE	18 NOV 2022	DRAWN GSF
SCALE@A3	1:2,500	CHECKED CR
STATUS	Planning	APPROVED RP

DWG. NO 4990-2001-T-085 **REV : P1**

No dimensions are to be scaled from this drawing.
All dimensions are to be checked on site.
Area measurements for indicative purposes only.

© LDA Design Consulting Ltd. Quality Assured to BS EN ISO 9001 : 2015
Sources Ordnance Survey

C:\USERS\GFLETCHER\PTVP - CAD\LDA_49902002_MALLARD PASS SOLAR FARM\CAD11.0.CURRENT\11.0.1.SHEETS\PROWS\4990-2001-T-079-089-P1 - TRAFFIC REGULATION MEASURES PLANS - TEMPORARY MEASURES.DWG

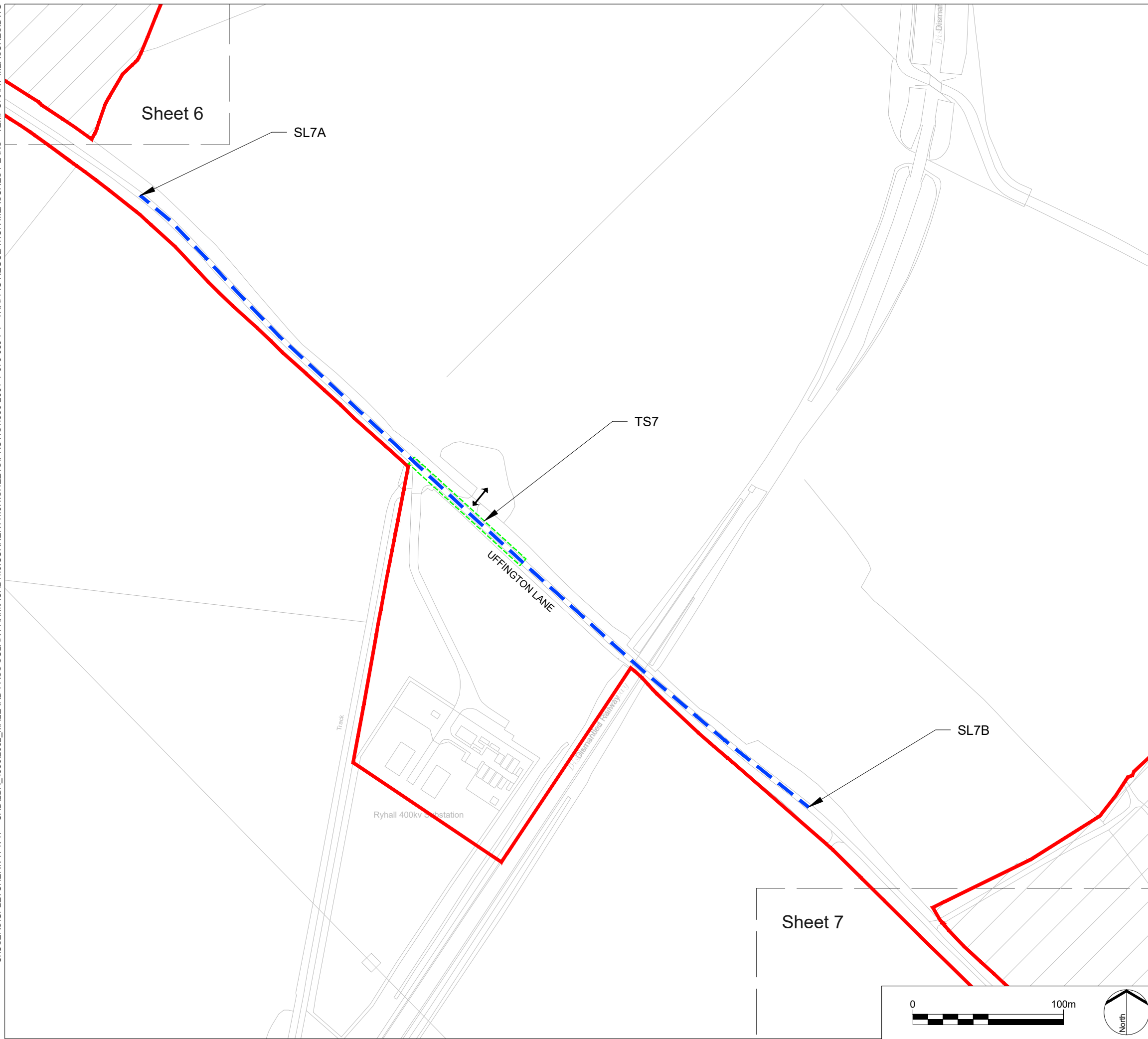

LEGEND

KEY PLAN:

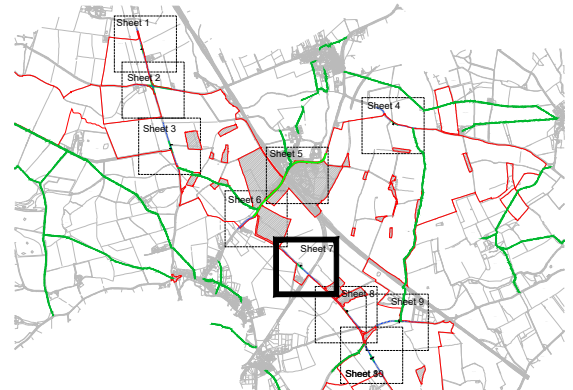

- Order limits
- Areas outside of Order limits
- Proposed Temporary Speed Limit (30mph Speed Limit)
- Proposed Temporary Traffic Signal Control Area
- Proposed Site Access Location
- Existing public right of way

- NOTES:
1. The Traffic Regulation Measures Plans should be read in conjunction with the Development Consent Order and the other plans and documents to be certified under it, in particular article 15, and Schedule 8 of the Development Consent Order.
 2. Information relating to the Public Rights of Way and accesses can be found on the rights of way and access plans.
 3. The Order limits has been drawn to the Land Registry boundaries and topographical survey data of the site. The accuracy of land registry and the topographical survey differs from the OS base mapping which results in the order limits not aligning with the line work shown on the OS mapping.
 4. Further information on the Public Rights of Way can be found on Figure 6.5 of the Environmental Statement.

REV.	DESCRIPTION	APP. DATE
P1	Addition of existing PRoW	RP 18/01/23
P0	Submission	RP 18/11/22



PROJECT TITLE
MALLARD PASS SOLAR FARM

DRAWING TITLE
TRAFFIC REGULATION MEASURES PLANS - TEMPORARY MEASURES - SHEET 7 OF 10
Infrastructure Planning (Applications: Prescribed Forms and Procedure) Regulations 2009
APFP Regulation: 5(2)(o)

PINS REFERENCE NO
EN010127

ISSUED BY	Oxford	T: 01865 887 050
DATE	18 NOV 2022	DRAWN GSF
SCALE@A3	1:2,500	CHECKED CR
STATUS	Planning	APPROVED RP

DWG. NO 4990-2001-T-086 REV : P1

No dimensions are to be scaled from this drawing.
All dimensions are to be checked on site.
Area measurements for indicative purposes only.

© LDA Design Consulting Ltd. Quality Assured to BS EN ISO 9001 : 2015
Sources Ordnance Survey

C:\USERS\GFLETCHER\PTVTP - CAD\LDA_49902002_MALLARD PASS SOLAR FARM\CAD11.0.CURRENT\11.0.1.SHEETS\PROWS\4990-2001-T-079-089-P1 - TRAFFIC REGULATION MEASURES PLANS - TEMPORARY MEASURES.DWG

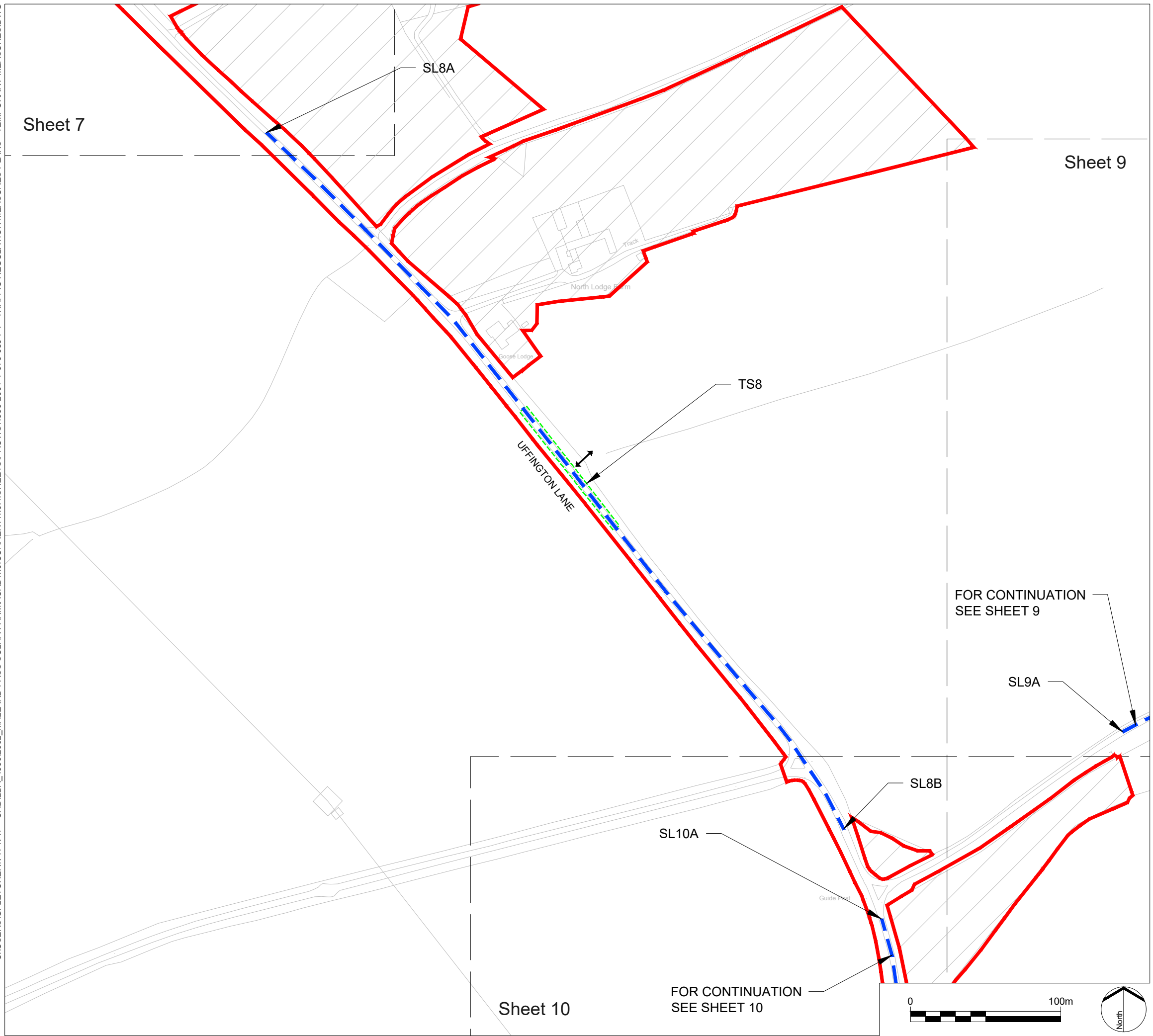

LEGEND

KEY PLAN:

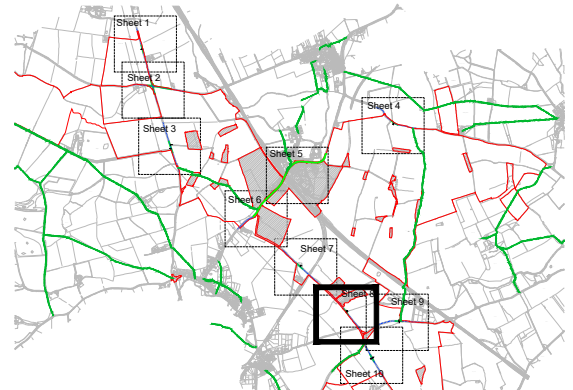

- Order limits
- Areas outside of Order limits
- Proposed Temporary Speed Limit (30mph Speed Limit)
- Proposed Temporary Traffic Signal Control Area
- Proposed Site Access Location
- Existing public right of way

- NOTES:
1. The Traffic Regulation Measures Plans should be read in conjunction with the Development Consent Order and the other plans and documents to be certified under it, in particular article 15, and Schedule 8 of the Development Consent Order.
 2. Information relating to the Public Rights of Way and accesses can be found on the rights of way and access plans.
 3. The Order limits has been drawn to the Land Registry boundaries and topographical survey data of the site. The accuracy of land registry and the topographical survey differs from the OS base mapping which results in the order limits not aligning with the line work shown on the OS mapping.
 4. Further information on the Public Rights of Way can be found on Figure 6.5 of the Environmental Statement.

P1	Addition of existing PRoW	RP	18/01/23
P0	Submission	MK	18/11/22
REV.	DESCRIPTION	APP.	DATE



PROJECT TITLE
MALLARD PASS SOLAR FARM

DRAWING TITLE
TRAFFIC REGULATION MEASURES PLANS - TEMPORARY MEASURES - SHEET 8 OF 10
 Infrastructure Planning (Applications: Prescribed Forms and Procedure) Regulations 2009
 APFP Regulation: 5(2)(o)

PINS REFERENCE NO
EN010127

ISSUED BY	Oxford	T: 01865 887 050
DATE	18 NOV 2022	DRAWN GSF
SCALE@A3	1:2,500	CHECKED CR
STATUS	Planning	APPROVED RP

DWG. NO 4990-2001-T-087 REV : P1

No dimensions are to be scaled from this drawing.
 All dimensions are to be checked on site.
 Area measurements for indicative purposes only.

© LDA Design Consulting Ltd. Quality Assured to BS EN ISO 9001 : 2015
 Sources Ordnance Survey

C:\USERS\GFLETCHER\VP\TP - CAD\LDA_4990\2002_MALLARD PASS SOLAR FARM\CAD\11.0.CURRENT\11.0.1.SHEETS\PROWS\4990-2001-T-079-089-P1 - TRAFFIC REGULATION MEASURES PLANS - TEMPORARY MEASURES.DWG

Sheet 8

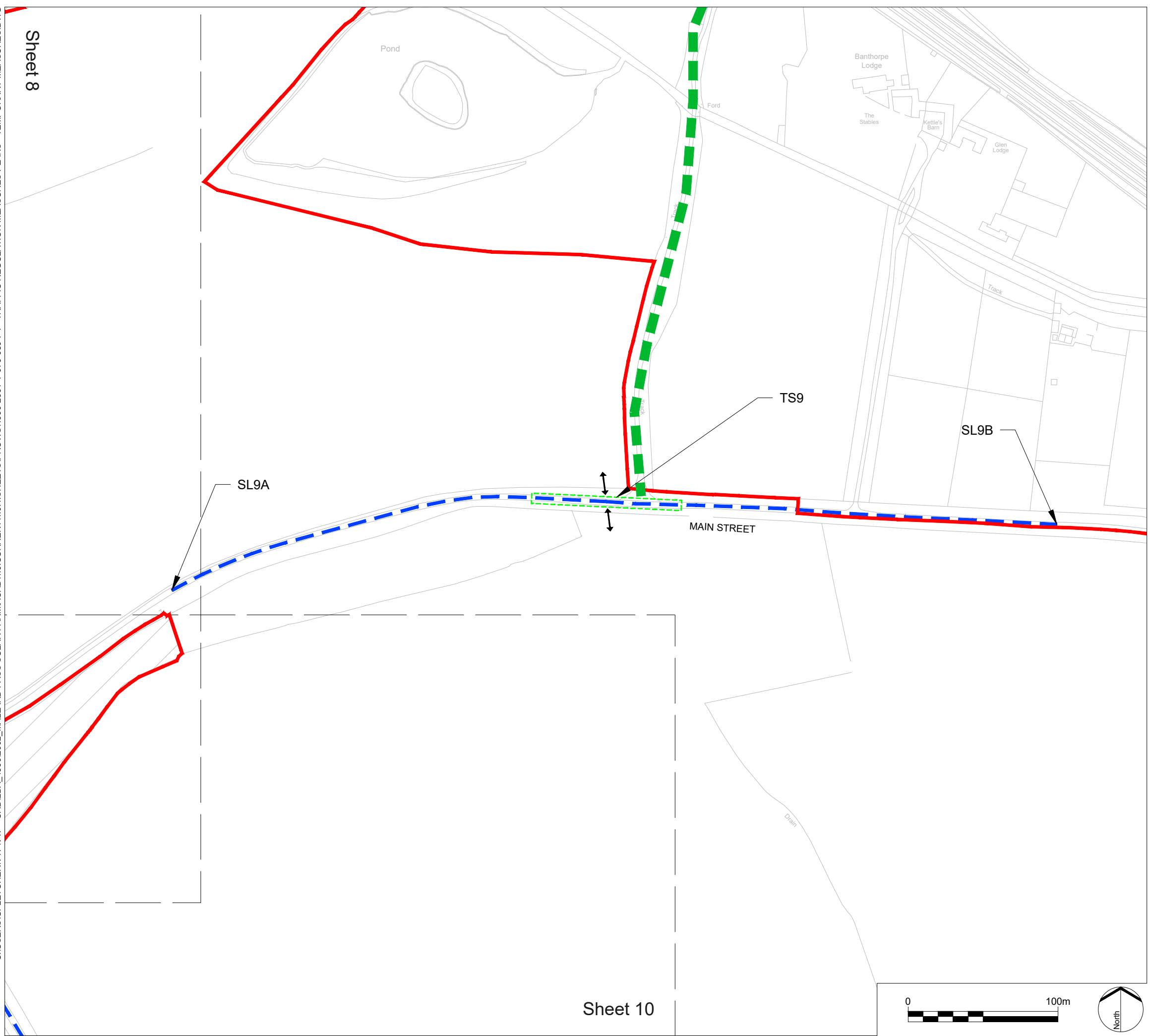

Sheet 10

LEGEND

KEY PLAN:

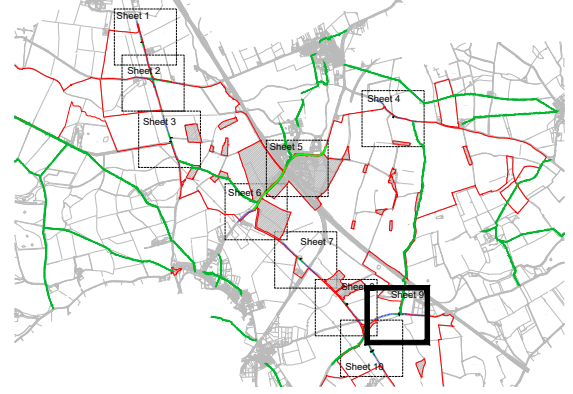

- Order limits
- Areas outside of Order limits
- Proposed Temporary Speed Limit (30mph Speed Limit)
- Proposed Temporary Traffic Signal Control Area
- Proposed Site Access Location
- Existing public right of way

NOTES:

1. The Traffic Regulation Measures Plans should be read in conjunction with the Development Consent Order and the other plans and documents to be certified under it, in particular article 15, and Schedule 8 of the Development Consent Order.
2. Information relating to the Public Rights of Way and accesses can be found on the rights of way and access plans.
3. The Order limits has been drawn to the Land Registry boundaries and topographical survey data of the site. The accuracy of land registry and the topographical survey differs from the OS base mapping which results in the order limits not aligning with the line work shown on the OS mapping.
4. Further information on the Public Rights of Way can be found on Figure 6.5 of the Environmental Statement.

REV.	DESCRIPTION	APP. DATE
P1	Addition of existing PRoW	RP 18/01/23
P0	Submission	RP 18/11/22



PROJECT TITLE
MALLARD PASS SOLAR FARM

DRAWING TITLE
TRAFFIC REGULATION MEASURES PLANS - TEMPORARY MEASURES - SHEET 9 OF 10
 Infrastructure Planning (Applications: Prescribed Forms and Procedure) Regulations 2009
 APFP Regulation: 5(2)(o)

PINS REFERENCE NO
EN010127

ISSUED BY	Oxford	T: 01865 887 050
DATE	18 NOV 2022	DRAWN GSF
SCALE@A3	1:2,500	CHECKED CR
STATUS	Planning	APPROVED RP

DWG. NO 4990-2001-T-088 REV : P1

No dimensions are to be scaled from this drawing.
 All dimensions are to be checked on site.
 Area measurements for indicative purposes only.

© LDA Design Consulting Ltd. Quality Assured to BS EN ISO 9001 : 2015

Sources Ordnance Survey

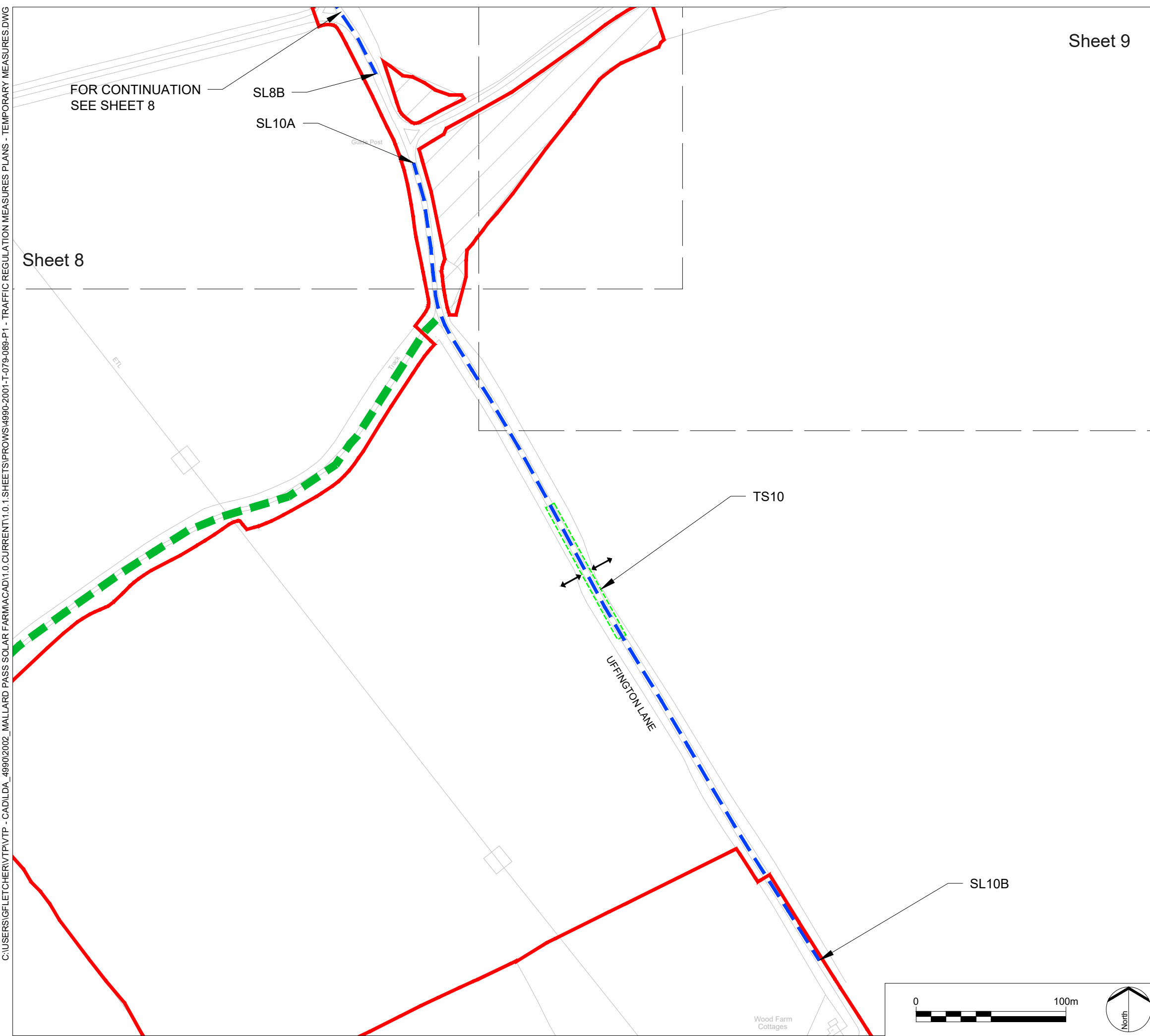

LEGEND

KEY PLAN:

- Order limits
- Areas outside of Order limits
- Proposed Temporary Speed Limit (30mph Speed Limit)
- Proposed Temporary Traffic Signal Control Area
- Proposed Site Access Location
- Existing public right of way

NOTES:

1. The Traffic Regulation Measures Plans should be read in conjunction with the Development Consent Order and the other plans and documents to be certified under it, in particular article 15, and Schedule 8 of the Development Consent Order.
2. Information relating to the Public Rights of Way and accesses can be found on the rights of way and access plans.
3. The Order limits has been drawn to the Land Registry boundaries and topographical survey data of the site. The accuracy of land registry and the topographical survey differs from the OS base mapping which results in the order limits not aligning with the line work shown on the OS mapping.
4. Further information on the Public Rights of Way can be found on Figure 6.5 of the Environmental Statement.

P1 Addition of existing PRoW	RP 18/01/23
P0 Submission	RP 18/11/22
REV. DESCRIPTION	APP. DATE

Mallard Pass Solar Farm

PROJECT TITLE
MALLARD PASS SOLAR FARM

DRAWING TITLE
TRAFFIC REGULATION MEASURES PLANS - TEMPORARY MEASURES - SHEET 10 OF 10
Infrastructure Planning (Applications: Prescribed Forms and Procedure) Regulations 2009 APFP Regulation: 5(2)(o)

PINS REFERENCE NO
EN010127

ISSUED BY	Oxford	T: 01865 887 050
DATE	18 NOV 2022	DRAWN GSF
SCALE@A3	1:2,500	CHECKED CR
STATUS	Planning	APPROVED RP

DWG. NO 4990-2001-T-089 REV : P1

No dimensions are to be scaled from this drawing.
All dimensions are to be checked on site.
Area measurements for indicative purposes only.

© LDA Design Consulting Ltd. Quality Assured to BS EN ISO 9001 : 2015
Sources Ordnance Survey

